

Giford

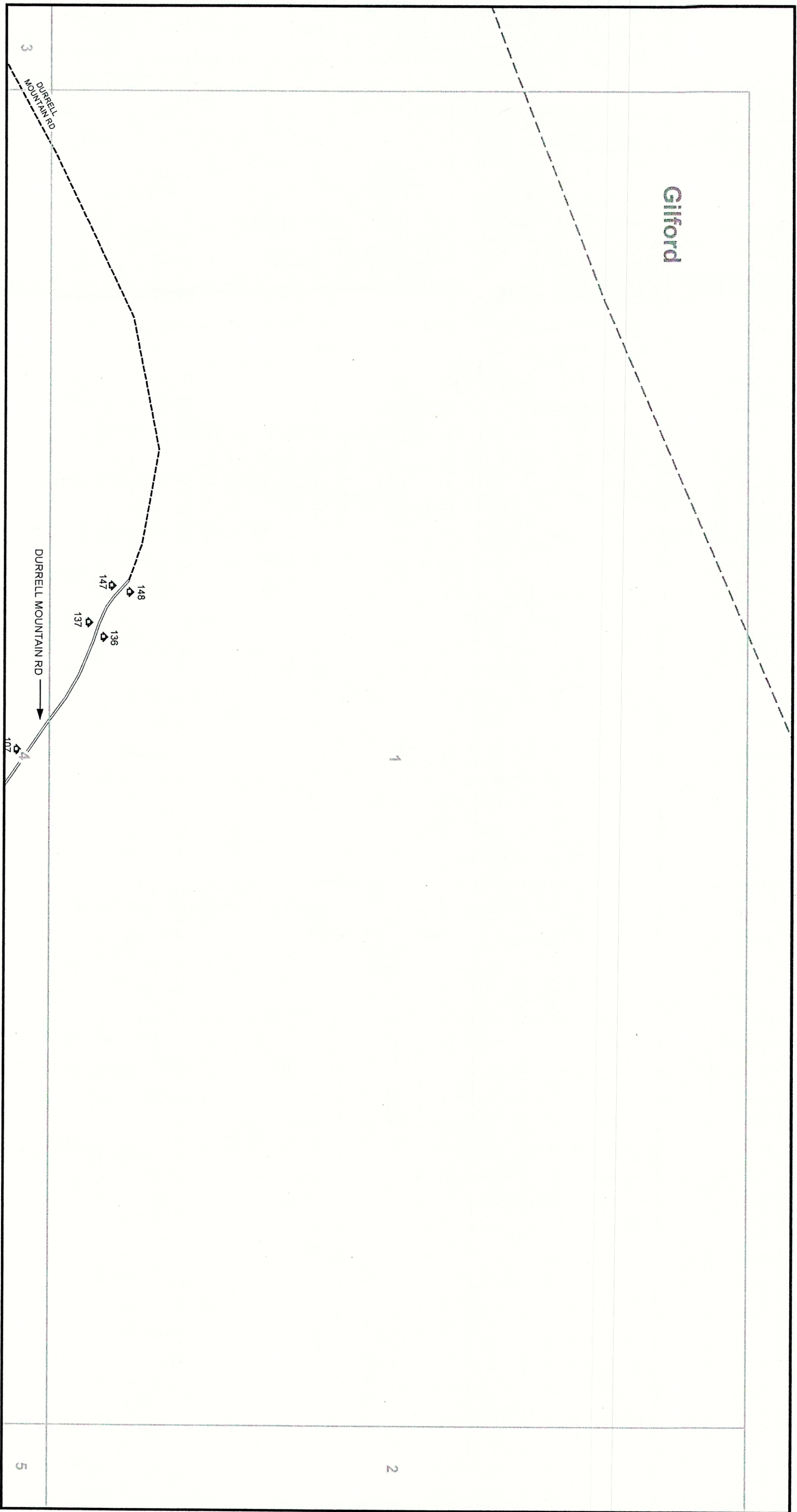

Address Increment: 50 ft.
 Coordinate System: State Plane
 Datum: NAD 1983
 Scale: 1:6,000
 1 Inch = 500 feet

	Residence		Fire Dept		Hydrant		Rest Area		Trailhead		Campground		Sheet Border		River		NH Route		
	Multi Residence		Police Dept		Hospital		Bridge		Backcountry		Payphone		Subject Town		Water		US Route		
	Business		School		Ambulance		Gate		Mountain Peak		Phone Box		Other Town		Public Rd		Other Rd		
	Multi Business		Church		Airport		Cemetery		Boat Launch		Crossover		County Boundary		Unclassified Rd		Driveway		
	Outbuilding		Government		Helipad		Tower		Recreation Area		Sign		County Boundary		Private Rd		Railroad		
																		Access GPS	
																			Landmark GPS

Gilmanton, NH

Enhanced 9-1-1 Addressing System

Prepared by: Bureau of Emergency Communications
 Data revised: January 30, 2006
 Printed: February 8, 2006
Address Map Sheet: 1